

TN – tija neascendenta
NRS – non rising stem

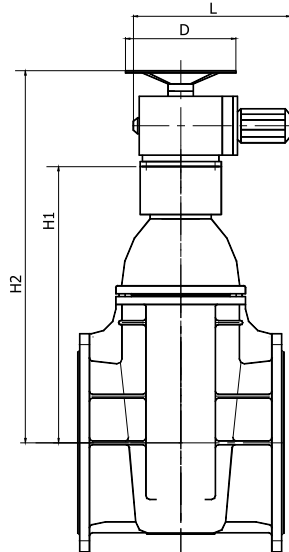

TA – tija ascendenta
OS&Y – rising stem

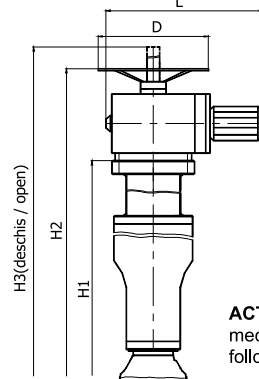

Dimensiuni cuplare actionare electrica
Connecting sizes of electric actuator

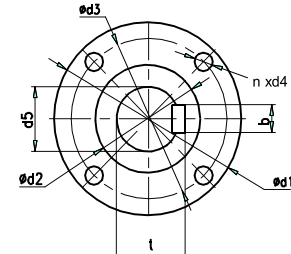

ACTIONARE ELECTRICA / ELECTRIC ACTUATION - echipare standard cu mecanism NOTOR in variantele / Standard equipped with NOTOR actuator in the following variants:

- NORMAL – cu cofret de forta si comanda / NORMAL - with electric switch box;
- ANTIEX Exd II BT 4 – fara cofret / ANTIEX Exd II BT 4 – without electric switch box

(dimensiuni in mm / dimensions in mm)

DN	H1		H2		H3	L1	D	Cursa x pasul Stroke x pitch	CARACTERISTICI NOTOR NOTOR'S CHARACTERISTICS				Durata cursei Stroke duration (sec)	Masa totala Total weight ≈(kg)	
	TN / NRS	TA / OS&Y	TN / NRS	TA / OS&Y					Tip Type	Moment maxim Max. torque (daNm)	Turatie iesire Output speed (rot/min)	Putere Power (kW)		TN / NRS	TA / OS&Y
50	320	317	605	602	602	575	250	55 x 4	N 0 AS	7	28	0.37	30	43	44
65	350	330	635	615	615			70 x 4					39	45	47
80	370	380	655	665	665			85 x 4					48	55	60
100	418	426	703	711	711			110 x 4					60	70	81
125	340	530	688	880	880	620	400	135 x 5	N 1 AS	14	28	0.55	58	115	126
150	400	581	748	930	930			160 x 5					71	125	135
200	566	725	914	1075	1075			215 x 6					78	165	175
250	606	850	954	1150	1150			265 x 6					95	221	246
300	734	1000	1082	1348	1400	645	400	315 x 6	N 2 AS	25	28	1.1	115	285	312
350	840	1170	1188	1518	1620			370 x 6					131	435	458
400	920	1314	1268	1662	1815			420 x 7					129	442	472
500	1500	1700	1850	2050	2250			520 x 7					159	622	722
600	1800	2245	2150	2500	2705		620 x 7	189	945	1055					

NOTA : constructie si materiale conform fisa RSO-10
NOTE : design and materials according to the technical sheet RSO-10

CERINTE PENTRU MECANISMUL ELECTRIC DE ACTIONARE / REQUIREMENTS FOR ELECTRIC ACTUATOR :

DN	50	65	80	100	125	150	200	250	300	350	400
Nr. rotatii / cursa Rotations/stroke	14	18	22	28	27	33	36	44	52	61	60
Moment min. actionare(daNm) Min. driving torque(daNm)	4	5	6	6.5	7	8	10.5	12.5	16		
Flanse prindere mec. ISO5210 Actuator connecting flanges ISO 5210	F10-B1			F14-B1			F14-B1				
d1	125			175			175				
d2	70			100			100				
d3	102			140			140				
n x d4	4 x 12			4 x 18			4 x 18				
d5	42			60			60				
t	45,3			64,4			64,4				
b	12			18			18				

Pentru confirmare va rugam folositi fisa tehnica contractuala / For confirmation, please use the technical sheet of agreement (FTC1)