

TN – tija neascendentă
 NRS – non rising stem

TA – tija ascendentă
 OS&Y – rising stem

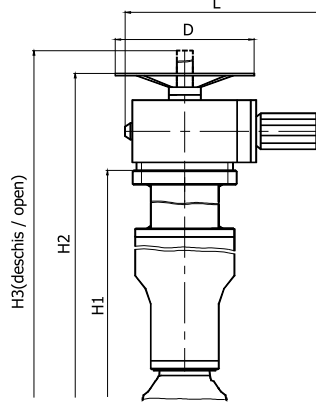

Dimensiuni cuplare actionare electrica
 Connecting sizes of electric actuator

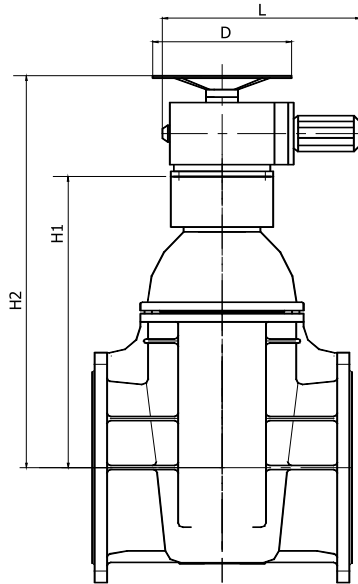
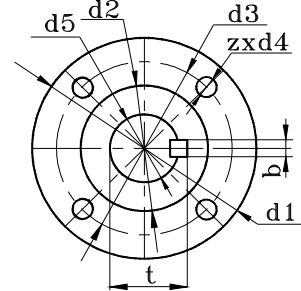

ACTIONARE ELECTRICA / ELECTRIC ACTUATION- echipare standard cu mecanism NOTOR in variantele/ Standard equipped with NOTOR actuator in the following variants:

- NORMAL – cu cofret de forta si comanda / NORMAL - with electric switch box
- ANTIEX Exd II BT 4 – fara cofret / ANTIEX Exd II BT 4 – without electric switch box;

(dimensiuni in mm / dimensions in mm)

DN	H1		H2		H3	L1	D	Cursa x pasul Stroke x pitch	CARACTERISTICI NOTOR NOTOR'S CHARACTERISTICS				Durata cursii Stroke duration (s)	Masa totala Total weight ≈(kg)	
	TN / NRS	TA / OS&Y	TN / NRS	TA / OS&Y					Tip Type	Moment max. Max. torque (daNm)	Turatie iesire Output speed (rot/min)	Putere Power (kW)		TN / NRS	TA / OS&Y
50	320	370	605	655	655	575	250	55 x 5	N0 AS	7	28	0.37	24	41	44
65	350	474	635	635	635			70 x 5					30	50	47
80	370	535	655	820	820			85 x 5					36	55	60
100	418	580	766	928	928	620	400	110 x 5	N1 AS	14	28	0.55	48	95	81
125	504	650	852	852	852			135 x 5					58	110	126
150	648	710	996	1058	1058			165 x 5					71	120	135
200	708	930	1056	1280	1280	645	400	215 x 6	N2 AS	25	28	1.1	78	225	235
250	802	1115	1150	1463	1463			265 x 6					95	303	313
300	902	1300	1250	1648	1650			315 x 6					112	381	392
350	1008	1450	1350	1800	1900			370 x 6					131	460	472

NOTA : constructie si materiale conform fisa RSO-16

NOTE : design and materials according to the technical sheet RSO-16

CERINTE PENTRU MECANISMUL ELECTRIC DE ACTIONARE / REQUIREMENTS FOR ELECTRIC ACTUATOR :

DN	50	65	80	100	125	150	200	250	300	350
Nr. rotatii / cursa Rotations/stroke	11	14	17	22	27	33	36	44	52	61
Moment min. actionare(daNm) Min. driving. torque(daNm)	6	6.5	7	10	10.5	11	12.5	16		17
Flanse prindere mec.ISO5210 Actuator connecting flanges ISO 5210	F10-B1			F14-B1			F14-B1			
d1	125			175			175			
d2	70			100			100			
d3	102			140			140			
z x d4	4 x 12			4 x 18			4 x 18			
d5	42			60			60			
t	45.3			64.4			64.4			
b	12			18			18			

Pentru confirmare va rugam folositi fisa tehnica contractuala / For confirmation, please use the technical sheet of agreement (FTC1)